



**Explore Genetic Technology to
Improve the Quality of Life**



Pluslife CPV Card

Canine Parvovirus

Rapid and accurate on-site POC molecular tests

Current Challenges



Lab environment and skillful technician required

PCR testing



TAT=1-3 days

Independent clinical lab testing



Low sensitivity

Antigen testing

Features

FAST
TAT within **30** mins

EASY
Hands-on time in **1~2** mins

ACCURATE
LoD of **1000** copies/mL

ACCESSIBLE
Sample to result within **3** steps

Pluslife CPV Card



Test Procedure

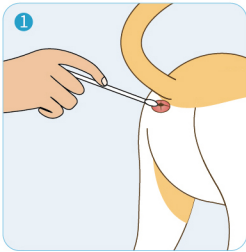

Collect Sample

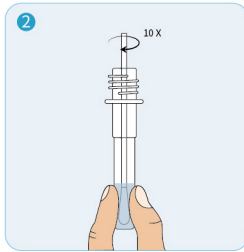

Mix Sample



Run Test

Result Output



✓ Mini Dock



✓ PC Software



✓ Mobile App

Application



Pet Hospital/Clinic



Pet Shop



Center for Animal
Disease Control

Specification

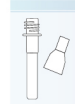
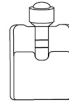
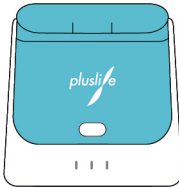

Pluslife Mini Dock	
Dimension	101 x 91 x 65 mm
Weight	210 g
Connection	Mobile phone or computer app
Operate temperature	15°C–30°C
Operate humidity	≤80%

Pluslife CPV Card	
Target pathogen	CPV
Sample type	Rectal swab
Limit of detection (LoD)	1000 copies/mL
Turnaround time (TAT)	30 mins
Shelf life	13 months at room temperature

Guangzhou Pluslife Biotech Co.,Ltd.

 Floor 3, Block E, Runhui Science & Technology Park, No.18 Shenzhou RD, Huangpu District, Guangzhou, Guangdong, China

 +86-20-31703986  market@pluslife.com  www.pluslife.com



Website



LinkedIn



Line